

smartload[™] Electric Dryer

DEGX1US
Installation instructions

Important safety instructions



To reduce the risk of fire, electric shock, or injury to persons when using your appliance, follow basic precautions, including the following:

1. Read all instructions before using the appliance.
2. Installation and service must be performed by a qualified installer or service agency.
3. Make sure the power cord is located so that it will not be stepped on, tripped over or otherwise subject to stress or damage.
4. Pressing the POWER button to turn the dryer off, does NOT disconnect the dryer from the power supply, even though the dryer lights are out.
5. Do not operate this dryer if it is damaged, malfunctioning, partially disassembled or has missing or broken parts, including a damaged cord or plug.
6. Do not dry articles that have been previously cleaned in, washed in, soaked in, or spotted with, gasoline, dry-cleaning solvents, other flammable or explosive substances as they give off vapors that could ignite or explode.
7. Close supervision is necessary if this dryer is used by or near children. Do not allow children to play inside, around or with this dryer or any other appliance.
8. Before the appliance is removed from service or discarded, remove the lid and drum door to the drying compartment.
9. Do not reach into the appliance if the drum is moving.
10. Do not install or store this appliance where it is exposed to water and or the weather.
11. Do not tamper with the controls or the lid lock.
12. Do not repair or replace any part of the appliance or attempt any servicing unless specifically recommended in the user-maintenance instructions or in published user-repair instructions that you understand and have the skills to carry out.
13. Unless specifically recommended by their manufacturer, do not use fabric softeners or similar products in a tumble dryer.
14. Do not use heat to dry articles containing foam rubber or similar textured rubber-like materials.
15. Check to see if the lint bucket needs emptying. Empty before the lint reaches the top of the transparent section (usually once a week).
16. Keep area around the exhaust opening and adjacent surrounding areas free from the accumulation of lint, dust, and dirt.
17. Have the interior of the appliance and exhaust duct cleaned periodically by qualified service personnel.
18. Do not place items exposed to cooking oils or other vegetable oils in your dryer. Items contaminated with cooking and other vegetable oils may contribute to a chemical reaction that could cause a load to catch fire.

SAVE THESE INSTRUCTIONS

Read this before you start installing your dryer



This is the safety alert symbol. This symbol alerts you to hazards that can kill or hurt you and others. The safety alert symbol and the word DANGER or WARNING will precede all safety messages. These words mean:



DANGER

You can be killed or seriously injured if you don't immediately follow instructions.



WARNING

You can be killed or seriously injured if you don't follow instructions.

All safety messages will identify the hazard, tell you how to reduce the chance of injury, and tell you what can happen if the instructions are not followed.

Check to make sure you have all the tools and parts necessary to correctly install this appliance.

Tools required

- ¼" nut driver or socket wrench
- Phillips screwdriver
- Flat-blade screwdriver
- Adjustable wrench that opens to 1" or 1" hex-head socket wrench (for adjusting the feet)
- Level
- Caulking gun and compound (for installing new exhaust vent)
- Gloves
- Safety glasses
- Knife
- Duct Tape

Parts supplied

- 2 feet inserts
- Check to make sure all parts have been supplied.

Accessories

- Kit Element 208V Part No 395500
- Mobile Home Installation Kit Part No 395488
- Drying Rack Part No 395332P

Parts needed

Check with local codes and read electrical and venting requirements (pages 8–18) before purchasing parts. If you need to purchase a power supply cord kit or power supply cable, they must meet the requirements on page 18.

To the installer

The correct installation of the dryer is your responsibility.

Be sure you read the following instructions carefully before you start to install the dryer. These instructions should be left with the home owner for future reference.

It is your responsibility to:

- Observe all governing codes and ordinances.
- Check code requirements. Some codes limit or do not permit installation of clothes dryers in garages, closets, mobile homes or sleeping quarters. Contact your local building inspector.
- Adhere to these installation instructions.
- Allow for spacing requirements with side by side installations (refer page 6).
- Make sure you have all items necessary for correct installation.
- Properly install the dryer.
- Contact a qualified installer to ensure that the electrical installation meets all national and local codes and ordinances.

Location requirements

 WARNING	
	<p>Explosion Hazard</p> <p>Keep flammable materials and vapours, such as gasoline, away from the dryer.</p> <p>Place dryer at least 18 inches (46 cm) above the floor for a garage installation.</p> <p>Failure to do so can result in death, explosion, fire, or burns.</p>

The dryer must be installed or stored in an area which is not exposed to water or weather.

It is extremely important that the dryer is installed in a well ventilated location. This dryer must exhaust air outdoors. Do not install the dryer in any room or closet which does not permit the free flow of replacement air.

Before installing the dryer ensure that there is sufficient height to fully open the lid. Allow sufficient room behind the dryer for the exhaust. The air intake is at the rear of the dryer. Ensure that there is a sufficient air passage on each side of the dryer for intake air.

The area in which the dryer is located must be kept clear and free from combustible materials, gasoline and other flammable vapours and liquids. A dryer produces combustible lint so the area around the dryer must be cleaned regularly to keep it free of lint.

This dryer can only be vented from the rear and must be exhausted to the outdoors.

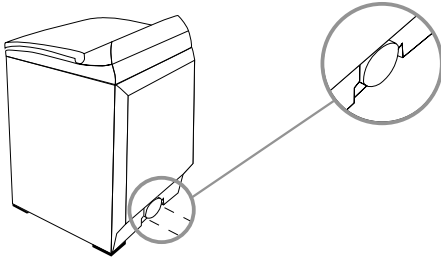

Alcove or closet installation

WARNING

When installing a dryer in a closet/alcove it must be exhausted to the outdoors. No fuel burning appliance can be installed in the same closet or alcove.

The top opening area in the door must be a minimum of 48 square inches (310cm²) and the bottom opening area must have a minimum of 24 square inches (155cm²). These openings must never be obstructed (a louvred door with the minimum air opening is acceptable). Minimum installation clearances are required but more clearance is recommended.

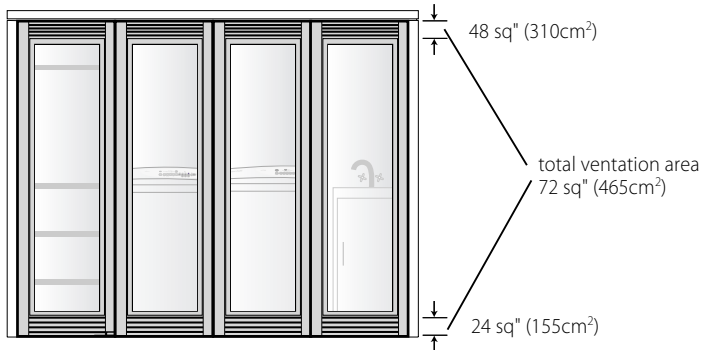
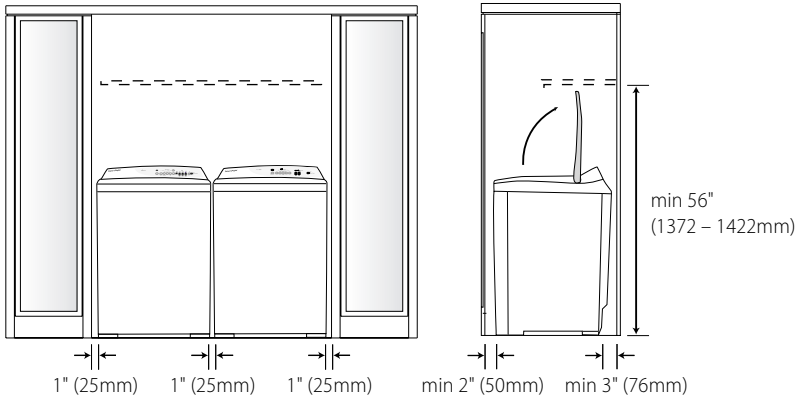

Dimensions

Lid clearance

Check that there is enough clearance for the lid to fully open.

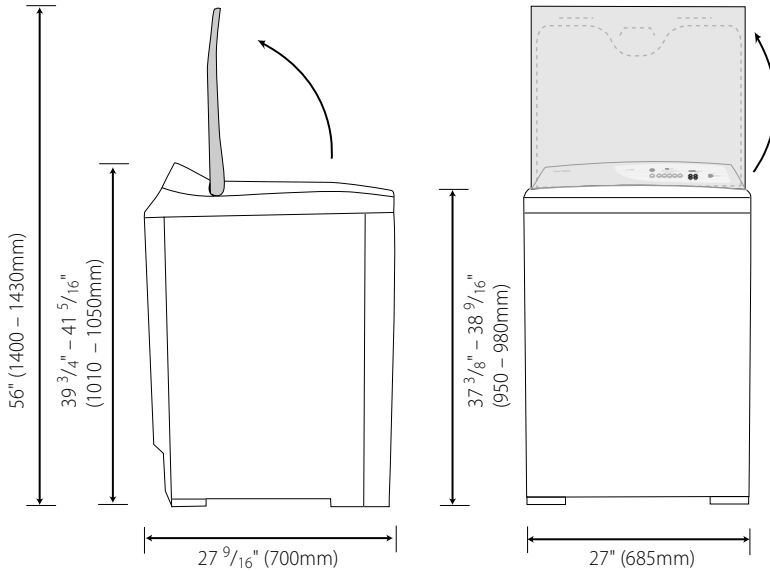

Exhaust outlet location

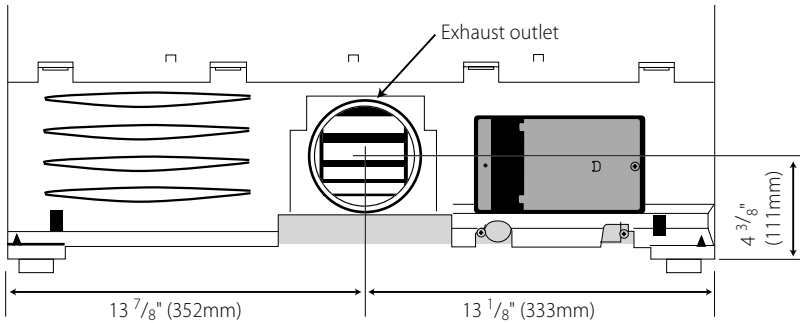

Mobile home installation

The installation of the dryer in a mobile home must conform to the Manufactured Home Construction and Safety Standard Title 24 CFR, Part 32-80 {formerly the Federal Standard for Mobile Home Construction and Safety, Title 24 HUD (Part 280), 1975} for the United States.

When installing a dryer in a mobile home, provisions for anchoring the dryer to the floor must be made.

A Mobile Home Installation kit is available with instructions (see Accessories page 3). Locate in an area that has adequate make up air (a minimum of 72 square inches of unobstructed opening is required).

Mobile home installations must be exhausted to the outdoors with the exhaust duct termination securely fastened to the mobile home structure, using materials that will not support combustion.

The exhaust duct must not terminate beneath the mobile home. See the section on exhausting for more information.

The dryer must be exhausted outside

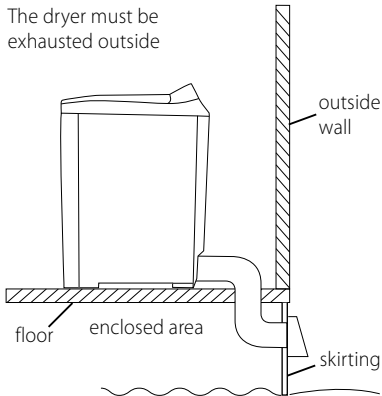

The exhaust vent must be securely fastened to a non-combustible portion of the mobile home structure and must not terminate beneath the mobile home.

Exhausting

The dryer must be exhausted to the outdoors. This will prevent the build up of lint and moisture in the room in which it is located and reduce the risk of fire.

! WARNING	
	Fire Hazard The dryer must be vented to the outdoors. Use rigid or thick wall flexible metal exhaust duct. Do not use a plastic exhaust duct. Do not use a metal foil exhaust duct. Failure to follow these instructions can result in death or fire.

This appliance must always be vented to the outdoors.

Exhaust ducting products can be purchased from your local Appliance store or Hardware store.

Plastic or metal foil flexible duct can kink, sag, be punctured, reduce airflow, extend drying times and affect dryer operation.

A minimum of 4 inch (100mm) thick wall flexible metal or rigid galvanised metal duct must be used. Using ducts larger than 4 inches (100mm) diameter may result in more lint accumulating.

Using straight rigid metal ducting will minimise lint accumulation. Thick wall flexible metal ducting may be used but care must be exercised to avoid sharp bends which may squash the duct & cause blockages. Do not use plastic ducting or thin wall flexible metal ducting.

Use duct tape to secure joints. Do not use screws as they collect lint.

Keep ducting as short and straight as possible. Do not exceed the maximum exhaust duct lengths stated later in these installation instructions.

Do not exhaust the dryer into a chimney or gas vent, a wall, a ceiling or any concealed space in a building. Do not exhaust the dryer under a house or mobile home or a porch, or into a window well or other area that will accumulate lint.

The exhaust duct should end with an exhaust hood with a swing out damper to prevent back drafts and entry of wild life. Never use exhaust hoods with a magnetic damper. The hood should have at least 12 inches (305mm) clearance between the bottom of the hood and the ground or other obstruction. The hood opening should point down. Never install a screen over the exhaust outlet.

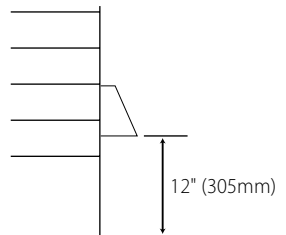

To reduce condensation, insulate any ducting which passes through unheated areas. Slope the duct gently downwards to the hood, to drain condensation and reduce lint build up. Avoid sag or loops in the duct as they may collect and store water and accumulate lint.

Before using an existing exhaust duct system for a dryer ensure that:

- No plastic or other potentially combustible duct or flexible metal foil ducting has been used.
- The duct is not pierced, kinked or crushed.
- The duct does not exceed the maximum recommended length for the new dryer.
- The exhaust hood damper opens and closes freely and with sufficient movement.
- Static pressure in the exhaust ducting does not exceed 1 inch (250Pa), or is not less than 0 inches of water column (ie. negative pressure), when measured with a manometer in the first 6 inches of the duct, with the dryer running on Air Dry (no heat) setting.
- The exhaust duct system meets all relevant local, state and national codes.

All ducting should be inspected and cleaned at least once a year to remove accumulated lint. Frequently check that the damper on the exhaust hood moves sufficiently and opens and shuts freely.

Mobile home installations

A Mobile Home Installation Kit is available (see Accessories page 3 and notes page 7).

Determine vent duct length

This dryer can only be vented from the rear and must be exhausted to the outdoors.

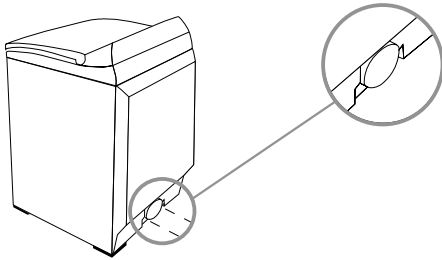

Different types of vent arrangements are shown below.

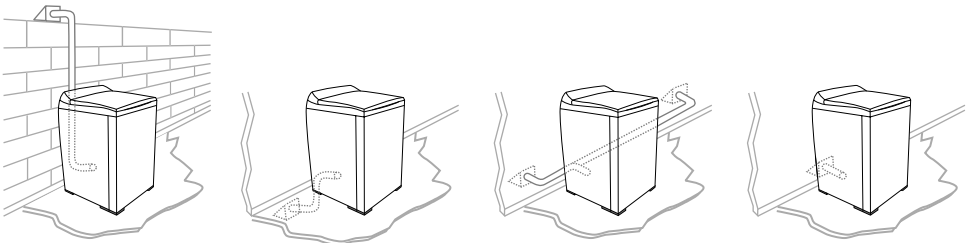

Choose a route that will provide the straightest and most direct path outdoors. Plan the installation to use the fewest number of elbows and turns.

When using elbows (rigid duct) or making turns (thick wall flexible metal duct), allow as much room as possible. With thick wall flexible metal duct bend duct gradually to avoid kinking and avoid 90° turns.

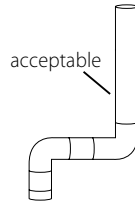
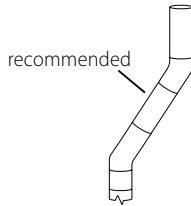

Maximum length of exhaust duct

The maximum length of the exhaust duct system depends upon:

- The type of ducts (rigid or thick walled flexible metal).
- The number of elbows or bends used.

1. Refer to the exhaust duct length chart that matches your hood type for the maximum duct lengths you can use. Do not use duct runs longer than specified in the exhaust duct length charts (refer to next page).

Exhaust duct systems longer than specified will:

- Accumulate lint creating a potential fire hazard.
- Shorten the life of the dryer.
- Reduce performance, resulting in longer drying times and an increased energy usage.

2. Determine the number of elbows/bends you will need.

3. In the column listing the type of metal duct you are using (rigid or thick wall flexible metal), find the maximum length of metal duct on the same line as the number of elbows/bends to be used (refer to next page).

Preferred 4" Hoods

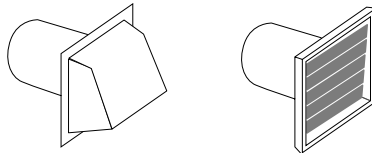

When you have a 4" (10cm) Hood

Number of 90° elbows/bends	Maximum length of 4" diameter metal duct.			
	Rigid		Thick Wall Flexible Metal (fully extended)	
0	64ft	19.5m	36ft	10.9m
1	54ft	16.5m	31ft	9.4m
2	44ft	13.4m	27ft	8.2m
3	35ft	10.6m	25ft	7.6m
4	27ft	8.2m	23ft	7.0m

Acceptable 2 1/2" Hood

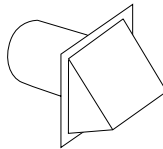

When you have a 2 1/2" (6cm) Hood

Number of 90° elbows/bends	Maximum length of 4" diameter metal duct.			
	Rigid		Thick Wall Flexible Metal (fully extended)	
0	58ft	17.6m	28ft	8.5m
1	48ft	14.6m	23ft	7.0m
2	38ft	11.5m	19ft	5.7m
3	29ft	8.8m	17ft	5.1m
4	21ft	6.4m	15ft	4.5m

For exhaust systems not covered by the exhaust duct length charts (such as multiple unit hook-ups, plenums, and power-assist fans), call our Customer Care Center: TOLL FREE 888 9FNP USA (888 936 7872).

Alternative installation for close clearances

Venting systems come in many varieties. Select the type best for your installation.
A close-clearance installation is shown.

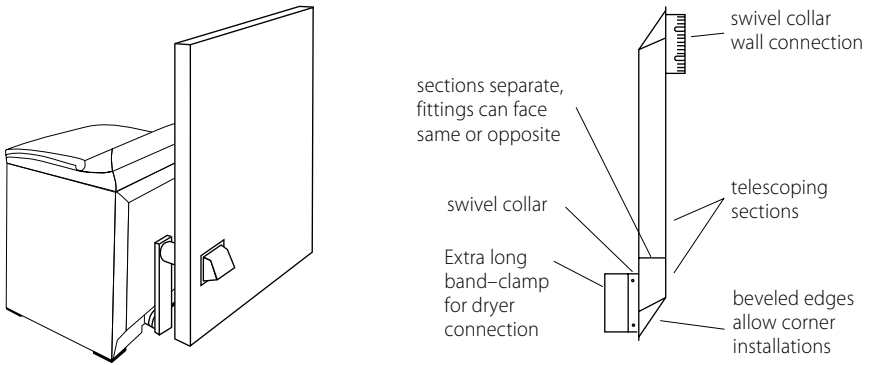

The maximum length using a 2" x 6" (5cm x 15cm) rectangular duct with two elbows and a 2 1/2"(6.3cm) exhaust hood is 8ft (2.4m).

Refer to the venting system kit manufacturers instructions.

Exhaust venting

WARNING



Fire Hazard

- Use heavy metal exhaust duct.
- Do not use a plastic exhaust duct.
- Do not use thin metal foil exhaust duct.
- Failure to do so can result in death or fire.

1. Read the exhaust section (page 8–12) before installing the exhaust system to determine the maximum allowable exhaust duct length.

Do not use sheet metal screws when assembling ducting. Always use suitable duct tape. Never use plastic or thin metal foil flexible exhaust material.

2. The exhaust outlet is located close to the center of the rear of the dryer. Make sure you join the exhaust duct to the dryer with duct tape only. This will prevent lint and dust from escaping from the dryer and exhaust system.

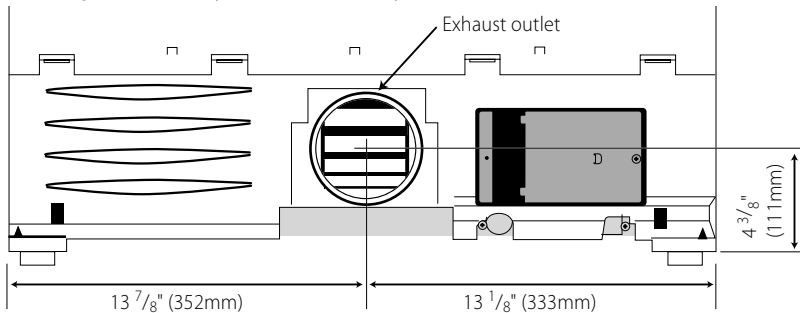

3. The exhaust vent can be routed up, down, left, right or straight out the back of the dryer. Refer to diagram.

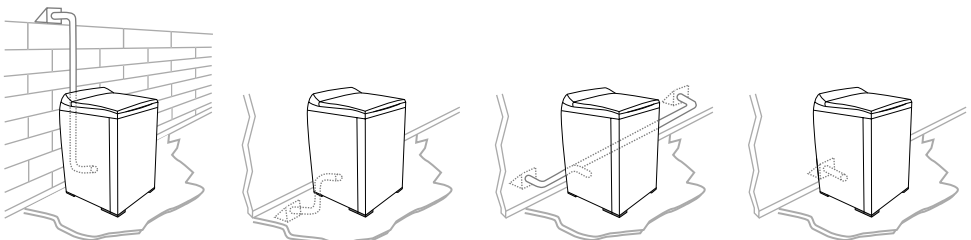

Installation

Parts and literature are packaged inside the dryer drum.

WARNING

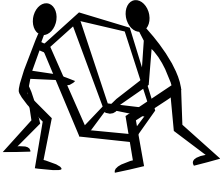

Excess Weight Hazard

**Use two or more people to move and install the dryer.
Failure to do so can result in back or other injury.**

Only remove the packaging at the customer's premises.

This will ensure the appliance arrives in pristine condition and reduces the risk of damage when transporting to the customer's home.

Unpacking

Make sure dryer is in a suitable location for installation.

Consider installing the dryer before the washing machine in a side by side installation, this will allow better access to electrical and exhaust connections.

Remove packaging

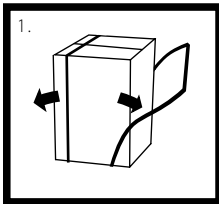

1. Remove straps.

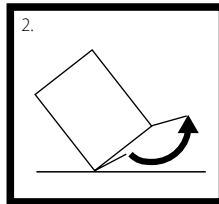

2. Unfold the bottom flaps on the carton.

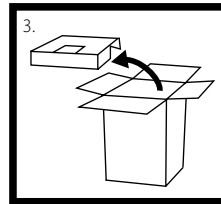

3. Unfold the top flaps on the carton, remove top packer.

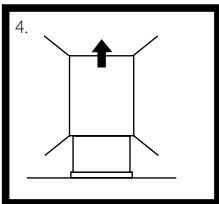

4. Remove the carton by lifting it off the product (do not cut the carton off).

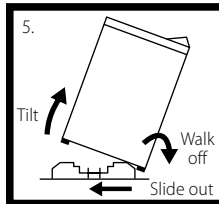

5. Remove the basepacker by tilting the product back and walking the product.

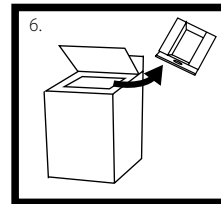

6. Remove the drum packer and the tape from the lint collector bucket in the drum.

Fitting the front feet

Note: Dryer is usually supplied with feet fitted and protruding the correct distance.

1. Tilt the dryer back using a hand trolley and making sure the trolley and dryer are secure.
2. Fit a rubber insert to each plastic foot as shown.

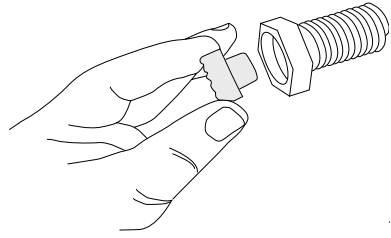
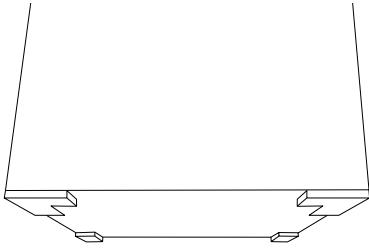

3. Screw the feet into the foot retainers on the left hand and right hand sides as shown.

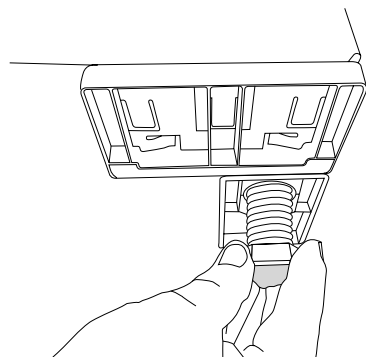
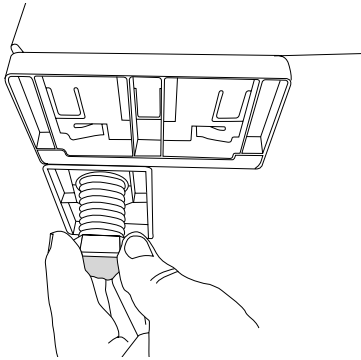

4. Screw both feet in so they protrude $\frac{1}{2}$ " (12mm) below the bottom of the wall on the foot retainers.

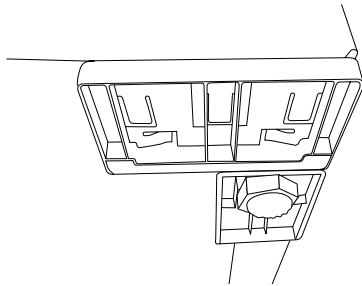
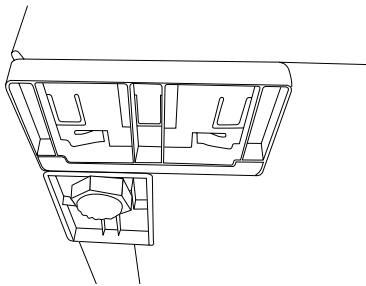

Electrical requirements

⚠ WARNING

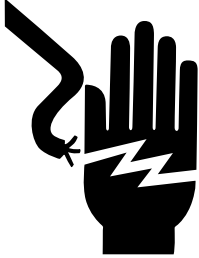

Electric Shock Hazard

Use a new UL approved 30-ampere power cord or direct wire cable.

Use a UL approved strain relief.

Disconnect power before making electrical connections.

Connect neutral wire (white or center wire) to center terminal.

On all four wire installations remove the grounding link and connect the ground wire to the green ground connecting screw.

Connect remaining 2 supply wires to remaining 2 terminals.

Securely tighten all electrical connections.

Failure to do so can result in death, fire, or electrical shock.

NOTE: The wiring diagram is located in the control console.

The dryer must be plugged into or connected to an individual branch circuit, do not use an extension cord.

The power supply must be 220/240V or 208V, 60 Hz approved alternating current electrical service. The electrical service requirements can be found on the data label that is located on the splash back. A 30-ampere fuse or circuit breaker is required on each of the lines.

If a power cord is used, the cord must be plugged into a 30-ampere receptacle.

The power cord is NOT provided with U.S. electric model dryers.

This dryer is supplied with the cabinet grounded through the neutral on the terminal block. If the dryer is to be installed in a mobile home or an area where local codes do not permit grounding through neutral, the appliance grounding link must be removed and a 4-wire power cord/cable or a separate grounding wire must be used.

Do not reuse a power supply cord/cable from an old dryer. The power cord/cable electric supply wiring must be retained at the dryer cabinet with a suitable UL listed strain relief.

208V Requirements

If your power supply is 208V 60 Hz, a new element kit must be fitted by a qualified electrician or service representative (see Accessories page 3 for kit part number).

WARNING

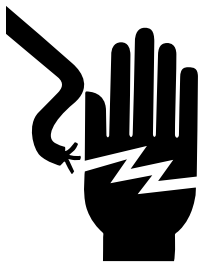

Electrical Shock Hazard

Make sure appliance is wired or plugged into a grounded outlet.

Do not use an adaptor.

Do not use an extension cord.

Failure to follow these instructions can result in death, fire, or electrical shock.

Grounding instructions

WARNING

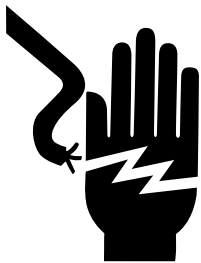

Electrical Shock Hazard

Check with a qualified electrician or serviceperson if you are in doubt as to whether the appliance is properly grounded.

Do not modify the plug if it will not fit the outlet.

Have the proper outlet installed by a qualified electrician.

Failure to follow these instructions can result in death, fire, or electrical shock.

Grounding for a cord-connected appliance

This appliance must be grounded. In the event of malfunction or breakdown, grounding will reduce the risk of electric shock by providing a path of least resistance for electric current. This appliance is equipped with a cord having an equipment-grounding conductor and a grounding plug. The plug must be plugged into an appropriate outlet that is properly installed and grounded in accordance with all local codes and ordinances.



WARNING

Improper connection of the equipment-grounding conductor can result in a risk of electric shock. Check with a qualified electrician or service representative if you are in doubt as to whether the appliance is properly grounded.

Grounding for a permanently connected appliance

This appliance must be connected to a grounded metal permanent wiring system, or an equipment grounding conductor must be run with the circuit conductors and connected to the equipment-grounding terminal on the appliance.

Power supply cord requirements for U.S.A

- Only a UL listed power-supply cord kit at least 6ft (1.8m) long and rated 120/240 V min, 30 A and marked with use for clothes dryers shall be used.
- This shall have ring terminals to connect to the dryer.
- The UL-rated strain relief included with it shall be suitable for a 1 1/8" (28.5mm) hole.

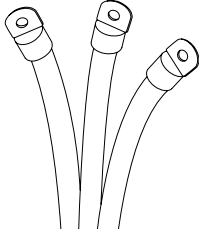

If your outlet looks like this

Choose this power supply cord

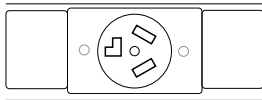

3 wire

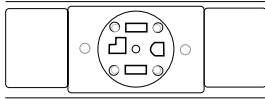
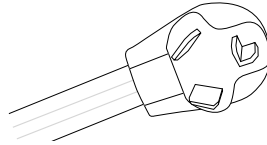

4 wire

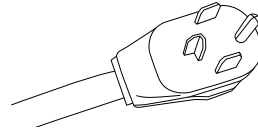

Connecting by direct wire

Power supply cable must match power supply (4-wire or 3-wire) and be:

- Flexible armoured or non-metallic sheathed copper cable (with ground wire). All current-carrying wires must be insulated.
- 10 gauge AWG solid copper wire (do not use aluminium wire).
- At least 6 feet (182 cm) long.
- A UL approved strain relief must be used.

Electrical connections

Please read **Electrical requirements and grounding instructions on pages 16–18 first.**

The DEGX1 electric model of the SmartLoad™ dryer is manufactured for a 3-wire connection system. The dryer frame is grounded by a link to the neutral conductor on the dryer terminal block. If local codes do not permit grounding through the neutral, the grounding link from the terminal block must be removed and a separate ground wire must be used.

The grounding link on the dryer must be removed for all 4-wire installations including new, remodelled construction, or mobile homes.

These Electrical Connection instructions provide for installing the SmartLoad™ dryer in the following situations:

- 3-wire connection where local codes **permit** grounding through the neutral.
- 3-wire connection plus separate grounding connector where local codes **do not permit** grounding through the neutral.
- 4-wire connection.

Each of the above connections can be made with an approved power supply cord or by direct wiring. Each connection instruction identifies the appropriate Power Supply Cord & covers requirements for direct wiring.

For 3-wire connections by power cords

3-wire power supply cord must have three 10 AWG copper wires and match a 3-wire receptacle of NMEA Type10-30R.

For 3-wire connections by direct wiring

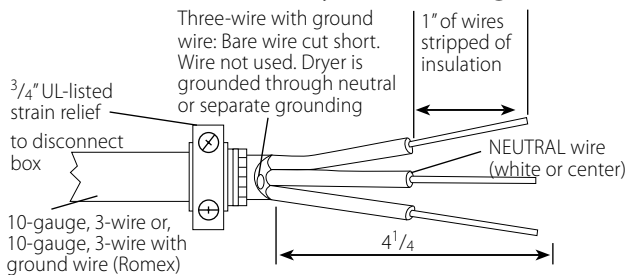

Strip 4 1/4\" of outer covering from end of cable. Strip insulation back 1\". If using 3-wire cable with ground wire, cut bare wire even with outer covering.



Shape ends of wire into a hook.

For 4-wire connections by power cords

4-wire power supply cord must have four 10 AWG copper wires and match a 4-wire receptacle of NMEA Type14-30R. The fourth wire (ground conductor) must be identified by a green cover and the neutral wire by a white cover.

For 4-wire connections by direct wiring

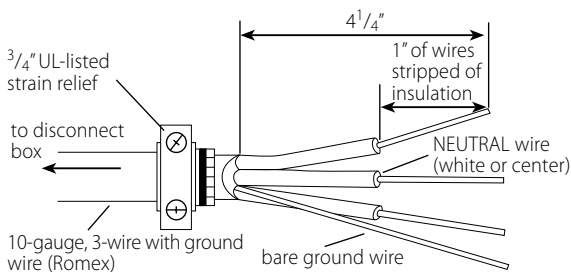

Strip 4 1/4\" of outer covering from end of cable. Strip insulation back 1\".



Shape ends of wire into a hook.

3-wire connections

For use where local codes **permit** grounding through the Neutral wire.

Use approved 3-wire Power Supply Cord or a 3-wire Cable for Direct Wiring as described on page 18.

1. Remove the terminal block cover plate.
2. Insert the power cord with a UL listed strain relief through the hole provided in the cabinet near the terminal block. Do not tighten strain relief screw until wiring connections are complete.
Note: a strain relief must be used.

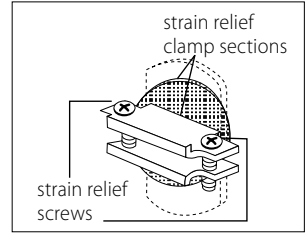
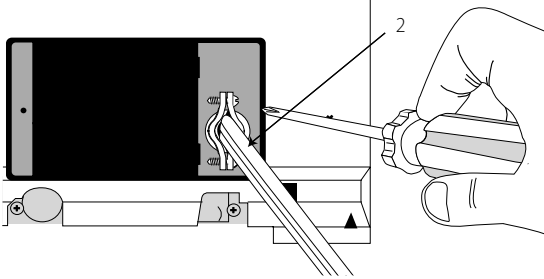

3. Loosen or remove the center terminal block screw. Connect the neutral wire (center) of the power supply cord to the center terminal screw of the terminal block. Tighten screw.
4. Connect the other wires to the upper and lower terminal block screws marked with the letter L. Tighten screws.

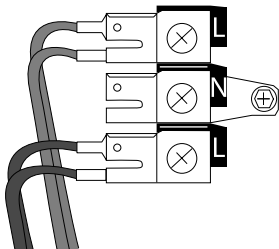

Note: If the appliance is moved back to a 3-wire installation the ground link must be refitted.

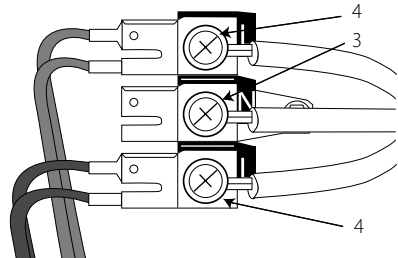

5. Refit terminal block cover by inserting the two tabs first on the rear panel of the dryer. Secure cover with securing screw.
6. Tighten strain relief screws.

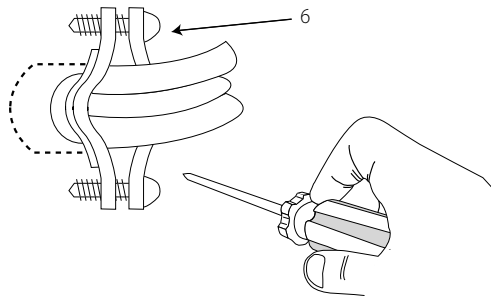
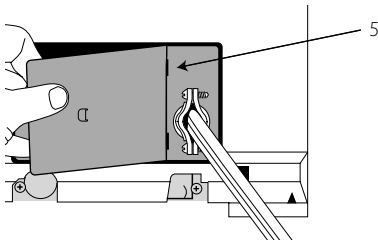

3-wire connections plus separate grounding connector

For use where local codes **do not permit grounding through the Neutral wire.**

Use approved 3-wire Power Supply Cord or a 3-wire Cable for Direct Wiring as described on page 18. A separate 10AWG copper grounding wire is required.

1. Remove the terminal block cover plate.
2. Insert the power supply cable with a UL listed strain relief through the hole provided in the cabinet near the terminal block. Do not tighten strain relief screw until wiring connections are complete.

Note: a strain relief must be used.

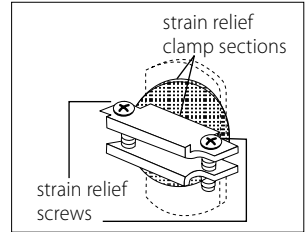
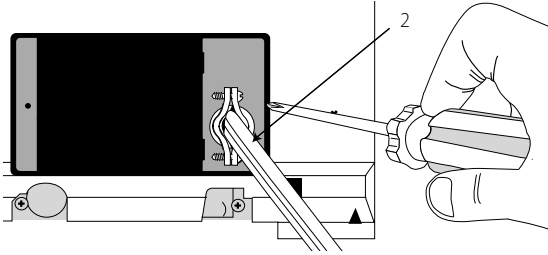

3. Remove center terminal block screw.
4. Remove appliance ground link by removing the ground connector screw (Green screw).
5. Connect a separate copper ground wire (green with yellow stripe) using the ground connector screw (Green screw). Make sure a ring terminal is used when connecting the ground wire and that the wire is firmly secured to an adequate grounding path.

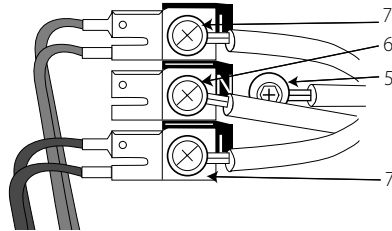
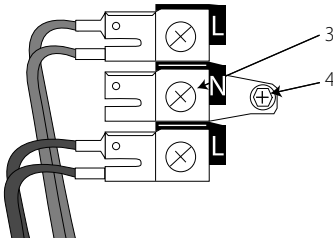

6. Connect the neutral wire (center) of the power supply cord to the center terminal screw of the terminal block. Tighten screw.
7. Connect the other wires to the upper and lower terminal block screws marked with the letter L. Tighten screws.
8. Refit terminal block cover by inserting the two tabs first on the rear panel of the dryer and secure cover with securing screw.
9. Tighten strain relief screws.

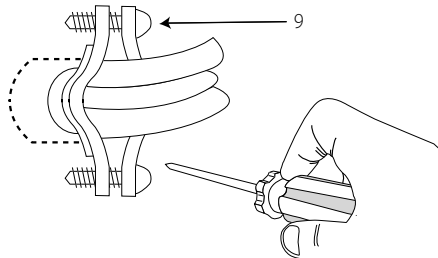
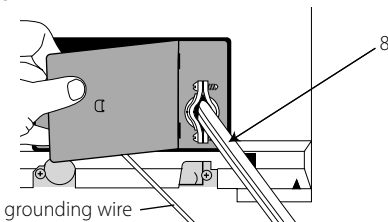

It is recommended that a qualified electrician determine that the ground path is adequate

4-wire connections

Use approved 4-wire Power Supply Cord or a 4-wire Cable for Direct Wiring as described on page 18.

1. Remove the terminal block cover plate.
2. Insert the power supply cable with a UL listed strain relief through the hole provided in the cabinet near the terminal block. Do not tighten strain relief screw until wiring connections are complete.

Note: a strain relief must be used.

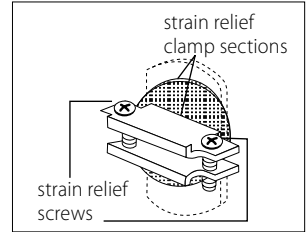
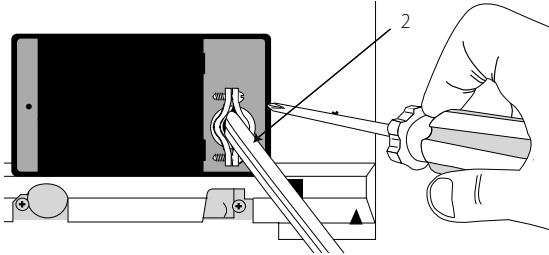

3. Remove center terminal block screw.
4. Remove appliance ground link by removing the ground connector screw (green screw).

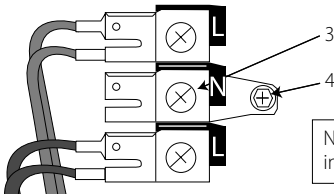

Note: If the appliance is moved back to a 3-wire installation the ground link must be refitted.

5. Connect ground wire (green) of the power supply cord to the ground conductor green screw. Tighten screw.
6. Connect the neutral wire (white) of the power supply cord to the center terminal screw of the terminal block. Tighten screw.
7. Connect the red wire and black wire to the upper and lower terminal block screws marked with the letter L. Tighten screws.

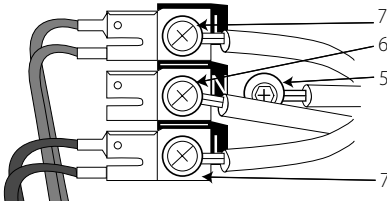

8. Refit terminal block cover by inserting the two tabs first on the rear panel of the dryer and secure cover with securing screw.
9. Tighten Strain Relief screws.

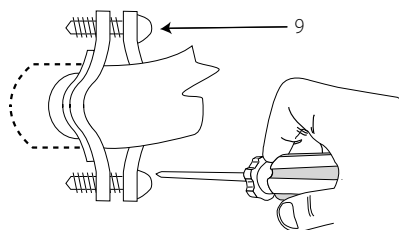
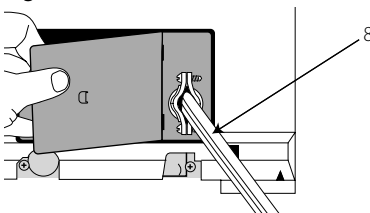

Level machine

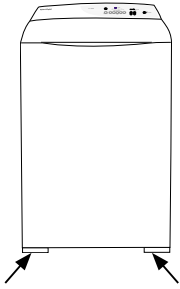

Check the dryer is level, and make necessary adjustments to the front levelling feet. The rear levelling feet are self adjusting.

Final installation check list

Check that:

- No plastic or flexible metal foil is used in the exhaust ducting.
- Exhaust is rigid ducting or thick wall flexible metal ducting.
- All joints in the ducting are made with duct tape – no screws are used.
- Ducting is clean and is connected to the dryer.
- Inserts are fitted to the two front feet.
- Dryer is level across the front.
- If installation is 208 V, special element kit has been fitted (see page 16).
- Dryer is plugged or directly wired into an approved fitting and is properly grounded.
- Dryer starts, heats, cools and shuts off.
- Customer has been shown how to use the dryer.

NB: This dryer has a drum reversal feature to reduce clothes tangle. Throughout the drying cycle the motor will run for four minutes, then stop & run in the opposite direction for forty seconds before reversing again.

Copyright Reserved © Fisher & Paykel 2004.

The product specifications in this booklet apply to the specific products and models described at the date of issue. Under our policy of continuous product improvement, these specifications may change at any time. You should therefore check with your Customer Care Center to ensure this booklet correctly describes the product currently available.

www.fisherpaykel.com

US

Installation Instructions

Published: 03/2004

Part No. 395217A